

MPRF Thermal Barrier Quick Start Guide (Model 2150)

Small O-rings: The small o-rings provided with this Thermal Barrier are designed to prevent moisture from leaking into the Thermal Barrier during operation. For proper operation, they need to be put on the probe of the data logger before putting the data logger in the thermal barrier.



1 Using scissors cut off the tip of the Silicone Compound tube. Spread a small amount of Silicone Compound on fingertips.



2 Spread a small amount of Silicone Compound onto seven (7) small O-Rings.



3 Put seven (7) small O-Rings over the tip of the probe of the data logger. Push them down to the bottom of the probe so that they go over the hub. Seven O-Rings will ensure that proper contact is made with the cap of the Thermal Barrier.

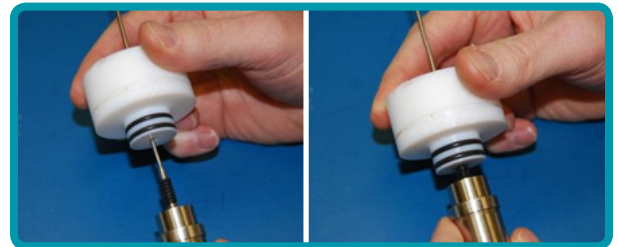

4 Put the cap of the MPRF Thermal Barrier over the top of the probe and push it all the way to the bottom of the probe, so that at least 3-4 of the small o-rings are forced up into the opening in the top of the cap. This provides a seal that ensures the MPRF Thermal Barrier performs to its specifications, especially when going through a vacuum cycle.



5 Insert the data logger into the opening of the Thermal Barrier.

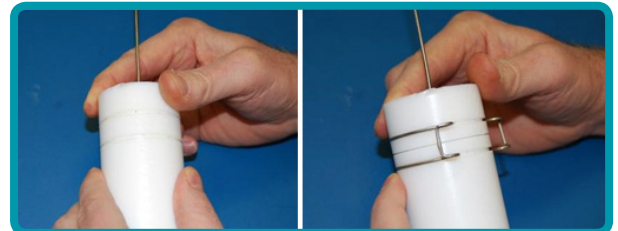

6 Push the cap into place and put the spring clamp on the Thermal Barrier in the allotted grooves. Ensure that the cap is now held firmly in place. The Thermal Barrier is now ready for operation.

NOTE: This process should be used when using MPRF Temperature Loggers with Rigid, Bendable, or Bendable Needle probes in a high-temperature environment.